

CLASSIC

FLUIDRA ARCHITECTS



equipment STANDARD



Classic design.
Natural wood of great quality.
Perfect detail





FLUIDRA ARCHITECTS

equipment SELECT

Front view

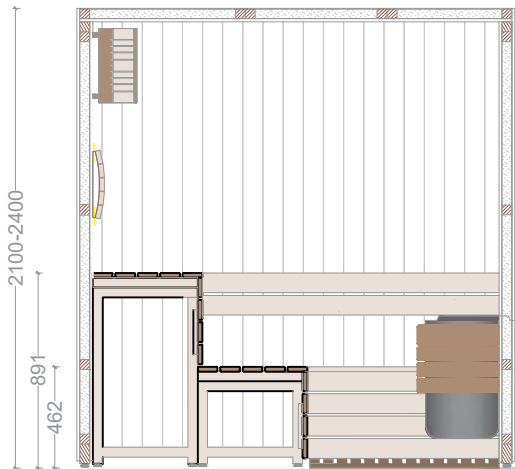

Top view

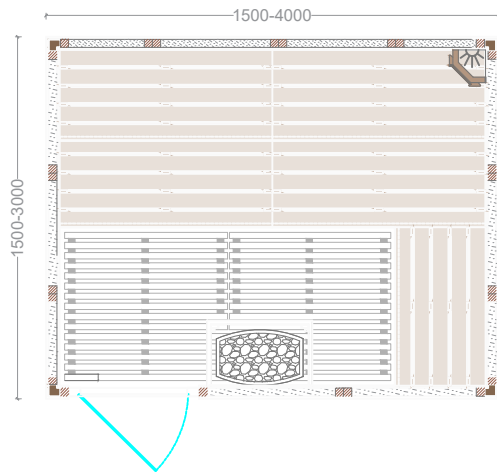

FLUIDRA ARCHITECTS

STANDARD

- .Construction of fir wood.
- .Vertical panelling of Spruce/Pine/Thermo Aspen/Hemlock/Red Cedar
- .Tongue and groove system for optimum sealing. Temperature resistance up to 150 ° C. .Thermal insulated inside with mineral wool and moisture insulated with aluminium foil .Floor grill made of Abachi wood
- .Dood: 8mm bronze tempered glass with wooden frame; wooden handle with roller closing mechanism
- .Closed Benches made of Solid Abachi /Thermo Aspen wood with low heat conductivity. Benches withstand the weight of 200 kg. Ergonomic back rests on second level.
- .Sauna light with wooden shade of Abachi.
- .El. sauna Heater . Power according to different sizes. Manual for installation and use. Heater protection grille of Abachi wood.
- .Outdoor Control panel
- .Silicon wiring 400 V III + N- wire + Ground wire
- .Sauna rocks
- .Air ventilation - ensuring a minimum of five air changes per hour
- .Wooden accessories set – bucket with ladle, combined thermo-hygrometer, sand timer

SELECT: equipment STANDARD +:

- *Touch control panel Xenio
- *Led strip light warm White 3000k

Options



Full glass front or glass window, tempered glass



Hidden heater with separation wall



SASL1 Aroma dosing

Fluidra Balkans JSC
190, GOLYAMOKONARSKO SHOSSE,
4027 PLOVDIV
BULGARIA
Tel. + 359-32-960-189
www.fluidra.com

CLASSIC

FLUIDRA ARCHITECTS